

# REL-TG-1.625

## Distribution Traveling Ground

Capacity: .25" to 1.625"

Weight: 4.85 lb.



Shown with optional  
ground assembly with a  
**REL-BGC-.81** clamp.



### Distribution Traveling Ground

Used to provide a grounding connection on the conductor during stringing operations.

The **REL-TG-1.625** features three aluminum sheaves, oil impregnated bushings, copper contact plates, and an adjustable spring-tension center roller assembly.

The grounding block allows connection of an appropriate ground assembly with a 5/8-18 UNC threaded ferrule, or the reversible stud will accept most ground clamp assemblies. (as shown above)



301 Ivyland Road • Warminster, PA 18974  
215-357-3500 or 800-966-3530  
[www.reliable-equip.com](http://www.reliable-equip.com)

### INSTRUCTIONS:

**Observe ALL Company, State and Local Safety Procedures and Grounding Practices.**

**NOTE: USE CLEAN AND DRY ROPE ONLY.**

Inspect traveling ground assembly, check movement of sheaves & tensioning assembly. Clean and check all contact surfaces. (i.e., copper contacts behind sheaves)

- Install traveling ground on the conductor being strung with the grounding connections on the bottom. Traveling ground should be between any potential source of current and the machinery or personnel to be protected.

Ensure the conductor moves freely through the assembly with enough tension to maintain proper contact.

- Attach one rope end to the eye. Attach the other end of the rope to a stationary object.
- Attach an appropriate grounding assembly for the current application to a suitable ground and the other end to the **REL-TG-1.625**.

**Additional information on reverse of this page.**

# REL-TG-1.625

## Distribution Traveling Ground

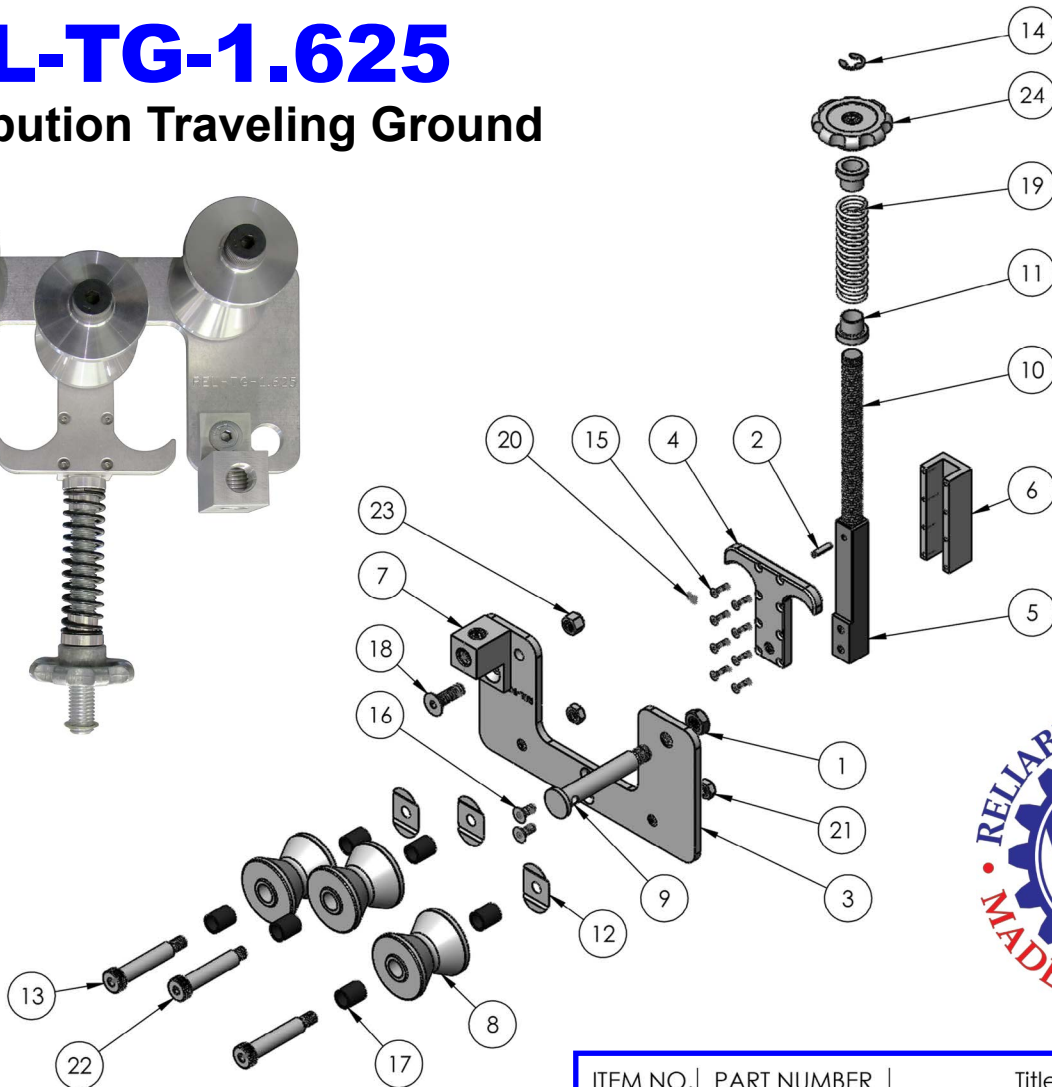

### CAUTION

The information in this document is intended to guide the user in the use and application of this tool. It is not intended as a substitute for proper training and experience in safe work practices for this type of equipment.

Consult a supervisor or safety personnel with any questions regarding the safe operation of this tool.



301 Ivyland Road • Warminster, PA 18974  
 215-357-3500 or 800-966-3530  
[www.reliable-equip.com](http://www.reliable-equip.com)

ITEM NO.	PART NUMBER	Title	QTY.
1	13409	JAM NUT 1/2-20 NYLOCK	1
2	82710	SPRING PIN 3/16 X 3/4 SS	1
3	82801	BASE PLATE	1
4	82802	ADJUSTING PLATE	1
5	82803	ADJUSTING BAR	1
6	82804	ADJUSTING GUIDE	1
7	82805	FERRULE BLOCK	1
8	82806	PULLEY	3
9	82807	STUD	1
10	82808	ADJUSTING ROD	1
11	82809	SHOULDER WASHER	2
12	82810	COPPER CONNECTOR	3
13	82811	SHOULDER BOLT 1/2" X 2 1/4; 3/8-16 THREAD	2
14	82812	E-CLIP 1/2" YELLOW ZINC	1
15	82813	FHCS #6-32 X 5/8 SS	8
16	82814	FHCS 1/4-20 X 5/8 SS	2
17	82816	BRONZE SLEEVE BEARING	6
18	82817	FHCS 3/8-16 X 1 1/4 ZINC	1
19	82818	SPRING	1
20	82819	SSS 8-32 X 1/4 B/O	1
21	82821	LOCKNUT 3/8-16 THIN ZINC	2
22	82822	MODIFIED SHOULDER BOLT	1
23	82823	LOCKNUT 3/8-16 ZINC	1
24	82824	KNOB MACHINED (5/8-11 THREAD)	1